

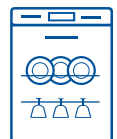

PRECISION SLIDE SOLUTIONS FOR APPLIANCES



About Accuride

Accuride International is a California-based company founded in 1962. Today the company has nearly one million square feet of manufacturing space around the world. It is the largest company in the world dedicated to the design and manufacture of ball bearing slide products.

Accuride has a global commitment to adhere to local environmental laws, using raw materials efficiently, and reducing waste. All Accuride production facilities have quality management systems registered to ISO 9001:2008. All slide finishes and components are RoHS compliant.

Your Development Partner

Accuride products are found in appliances offered by leading manufacturers throughout the world. In addition to a proven track record of reliable slide solutions, Accuride offers a deep level of support. A dedicated project management team is assigned to each and every venture and we partner with our clients from concept to completion. This team includes engineers from all disciplines to provide the knowledge and technical support to take designs from a great idea to fruition.

We are experts in 3-D modeling, rapid prototyping, tool design and building, and state-of-the-art quality systems. Frequently, we integrate our products into customer units and parallel test according to the project specifications. These things combined, allow us to develop cost-effective product solutions—while adhering to aggressive market-driven timelines.

Table of Contents

Application-Specific Features & Benefits

Refrigeration.....	1
Cooking.....	2
Dishwashers.....	3
Laundry	3
Special Features	4
General Slide Selection Factors	5
Cross Section Guide.....	5

Refrigeration

Accuride slides offer key features designed to meet the demands of refrigeration products including side-by-side refrigerators, bottom mount refrigerators, under-counter refrigerated drawers, wine drawers, and freezers.

- Food grade grease is used for lubrication.
- All components and lubrication are designed to resist a wider range of temperatures.
- Fitted with stainless steel ball bearings and ball retainers to resist corrosion.
- Customization available for lift-off drawer disconnects.
- Custom metal brackets and polymer slide sleeves, shrouds, or holders are available.
- Stainless steel is available.
- Finishes (check for availability):
 - Zinc (C)
 - Zinc with moisture-resistant coating (CH, CE, CP**)
 - White Electrocoat (EW)
 - Black Electroplate (CB)

Light- & Medium-Duty Applications

- Shelves, trays, baskets, bins, drawers
- Pantry, deli, or crisper compartments
- Wine drawers/shelves
- Under-counter refrigerated drawers

Recommended Slide Solutions

Aero 6331, 2700, 2132, 201, 3732, 3832*

Heavy-Duty Applications

- Bottom-mount freezer drawers
- Wide under-counter refrigerated drawers

Recommended Slide Solutions

3600, 3601, 3620, 3640, 7950, 9301*

* See page 5 for slide cross sections and load rating information.

** 96, 120 and 250 hours NSF salt spray testing





Cooking & Ovens

Accuride offers sliding solutions that provide the ultimate in smooth, safe movement for cooking-related applications.

- Lubrication with high-temperature food grade-approved grease.
- Designed to meet industry cycle-testing requirements.
- Unit provides easy installation and removal.
- Smooth ball-bearing slide movement
- Slide options include cold rolled steel with nickel plating or stainless steel construction.

Applications

Oven Ranges and Ovens

- Oven Racks
- Baking Drawers
- Warming Drawers
- Ventilation (downdraft vents)
- Articulating control panels



Ovens & Warming Drawers

Recommended Slide Solutions

2700 slides* and brackets.

3600, 3601, 3620, 3301, 3320, 3820, 3832, Aero 6331*

Ventilation & Downdraft Vents

Recommended Slide Solution

201*

* See page 5 for slide cross sections and load rating information.

Dishwashers

Accuride products for dishwashers are constructed of materials designed to take the abuse of high temperatures, detergent, and water. We recommend model 2734, a stainless steel slide with a stout construction that offers good resistance to side-to-side racking of the basket and downward deflection. It also includes the following features specifically designed for dishwasher applications:

- End caps, basket height adjust, and disconnect components fabricated from durable and detergent-resistant polymers.
- Over-travel option to allow loading and unloading access where countertop overhangs are present.
- Optional debris drainage holes incorporated into slide members.
- Smooth slide movement is maintained in high temperature environment.



Washers & Dryers

Whether furnishing storage for laundry supplies or extra workspace for folding and sorting, Accuride slides provide the means to enhance laundry products.

Finishes (check for availability):

- Zinc (C)
- Zinc with moisture resistant coating (CH)
- White Electrocoat (EW)
- Black Electroplate (CB)

Applications

- Drawers for storage pedestals and towers
- Detergent or bleach dispensing drawers
- Laundry pull-out shelves

Recommended Slide Solutions

201, 2132, 3301, 3320, 3832, Aero 6331*



* See page 5 for slide cross sections and load rating information.

Special Features

Accuride offers a variety of special features to enhance drawer operation. Talk to your Accuride representative for more information regarding availability.

Self-Closing

Applications: bottom-mount freezer drawers, under-counter appliance drawers, warming drawers, and laundry pedestal drawers.

Description:

- Helps bring drawers to a close, preventing bounce back and re-opening.
- Mechanism may be integrated or external to slide profile.

Benefits:

- Strong detent holds drawers closed, ensuring a good seal.

Easy-Close (soft-close)

Applications: bottom-mount freezer drawers, crisper and deli drawers, and warming drawers.

Description:

- Brings drawers to a smooth, gentle close.
- Mechanism may be integrated or external to slide profile.

Benefits:

- Helps to prevent slam and bounce back of drawers.
- Quiet operation.
- Smooth movement and soft-closing matches drawer movement of high-end cabinetry in today's fine kitchens.

Touch Release (push-to-open)

Applications: Laundry pedestals and folding shelves, crisper and deli drawers, and warming drawers.

Description:

- Drawers or shelves are held in a closed position until the drawer front is depressed. This releases the slide, propelling it open approximately 2 inches (50mm).

Benefits:

- Eliminates the need for knobs or pulls.
- Provides for hands-free operation in toe-kick applications.

Moisture-Resistant

Plating Options

Applications: Refrigeration

Description:

- Provides stronger resistance to corrosion.
- Smoother finishes reduce drag and enhance product movement.

Available Options:

- Standard appliance finish protects up to 96 hours of salt spray protection.
- Optional finishes up to 500 hours of salt spray protection**.

General Slide Selection Factors

Although appliance applications have unique considerations, there are basic factors that influence the slide solution.

- The intended weight carried by the drawer (load rating).
- The desired height, width, and depth of the drawer.
- The space available between the drawer and the cabinet (side space).
- The depth of the cabinet.
- The travel or extension, which determines drawer access.
- Whether the drawer requires a method of disconnect for removal.

Additional factors specific to the application:

- Special features to enhance operation including detents, self-closing and soft-closing.
- Mounting requirements
- High or low temperatures
- Corrosion resistance

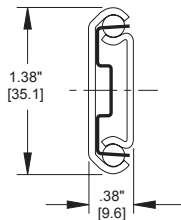

201
3/4 extension
Up to 108-lb. load rating

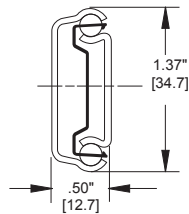

2132
3/4 extension
Up to 75-lb. load rating

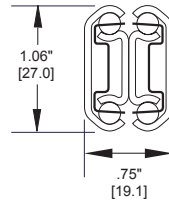

2700/2734
Full/Over extension
Up to 75-lb. load rating

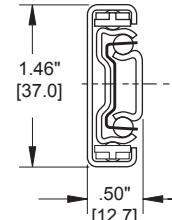

3732
Full extension
Up to 100-lb. load rating

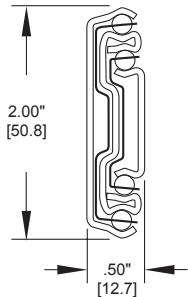

3301
Over travel
Up to 150-lb. load rating

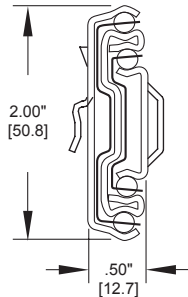

3320
Full extension
Up to 120-lb. load rating

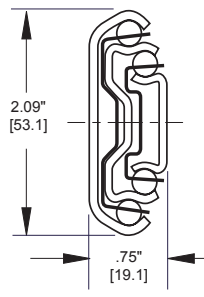

3600/3640
Full extension
Up to 273-lb. load rating

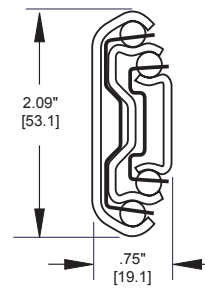

3601
Over travel
Up to 255-lb. load rating

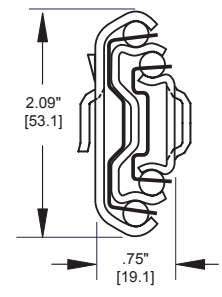

3620
Over travel
Up to 200-lb. load rating

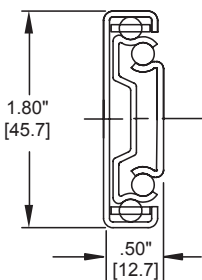

3832
Full extension
Up to 100-lb. load rating

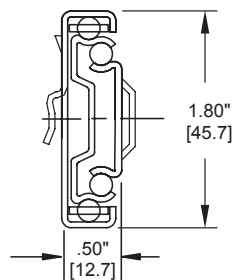

3820
Full extension
Up to 100-lb. load rating

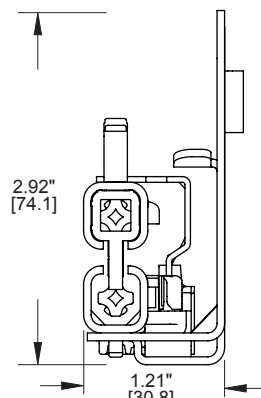

Aero 6331
Full/Over extension
Up to 110-lb. load rating

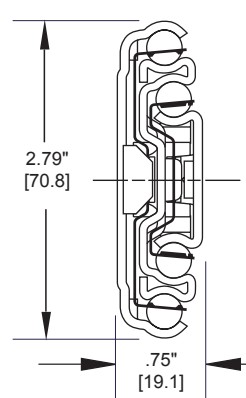

7950
Full extension
Up to 350-lb. load rating

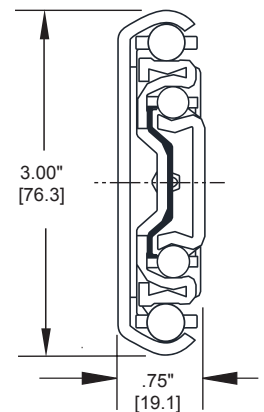

9301
Full extension
Up to 600-lb. load rating

NOTE: Load ratings are subject to variation based on application specifics. Published load ratings for appliance applications are lower than those stated for general industrial applications due to the higher cycle count requirements and environmental factors.

Accuride International Inc.

United States

Global Headquarters

12311 Shoemaker Ave.
Santa Fe Springs, CA 90670

Telephone: (562) 903-0200
Fax: (562) 903-0208

www.accuride.com
oemdirect@accuride.com

United Kingdom

Liliput Rd.
Brackmills Industrial Estate
Northampton, NN4 7AS
United Kingdom

Telephone: +44 (0) 1604-761111
Fax: +44 (0) 1604-767190
www.accuride-europe.com
saleseurope@accuride.com

China

No. 178, Suhong East Road
Suzhou Industrial Park
Jiangsu Province, China 215026

Telephone: +86-512-62731200
Fax: +86-512-62833993
www.accuride.com.cn
saleschina@accuride.com

Mexico

Calle Circuito Norte No. 6
Parque Industrial Nelson
Mexicali, BC, C. 21395
México

Germany

Werner-Von Siemens-Strasse 16-18
65582 Diez/Lahn
Germany

Telephone +49 (0) 6432-608-0
Fax: +49 (0) 6432-608-320
www.accuride-europe.com
saleseurope@accuride.com

Japan

44 Minami-asaji
Iwata Yawata-shi
Kyoto, Japan

Telephone: +81 (75) 983-7500
Fax: +81 (75) 983-9500
www.accuride.co.jp
info@accuride.co.jp

Accuride
Always Moving Forward

www.accuride.com



@accurideUS



accurideIntl



accuride-international-inc

09-2019